

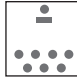



Steigenberger Frankfurter Hof

Salon 4-5

Fläche (m ²) Size (sqm)	Höhe (m) Height (m)	Länge (m) Length (m)	Breite (m) Width (m)	Türgröße (m) Door Dimensions (m)	Flächenlast (kg/m ²) Max. Weight (kg/sqm)
109,00	2,70	20,35	5,30	1,99 x 2,45	500 kg/m ²

					
Parlamentarisch Class room 50	Stuhlreihen Theatre 70	U-Form U-Shape 30	Block Board room 32	Bankett Round tables 52	Empfang Reception 90

 **Verfügbare Stromanschlüsse** - Available plug connections

 **Datenanschluss, Telefon / Fax Anschluss**, - Data outlet, Phone / Fax outlet,

 **W-LAN** - Wireless fidelity

 **Feste Einbauten** - Fixtures

 **Leinwand** - Screen,

 **Zugang über Treppe** - Access via staircase

 **Lastenaufzug** - Freight elevator

 **Ebenerdiger Zugang** - Level access

Steigenberger Frankfurter Hof · Am Kaiserplatz · 60311 Frankfurt/Main · Germany

Telefon: +49 69 215-02 · Telefax: +49 69 215-900

frankfurter-hof@steigenberger.de · www.frankfurter-hof.steigenberger.de

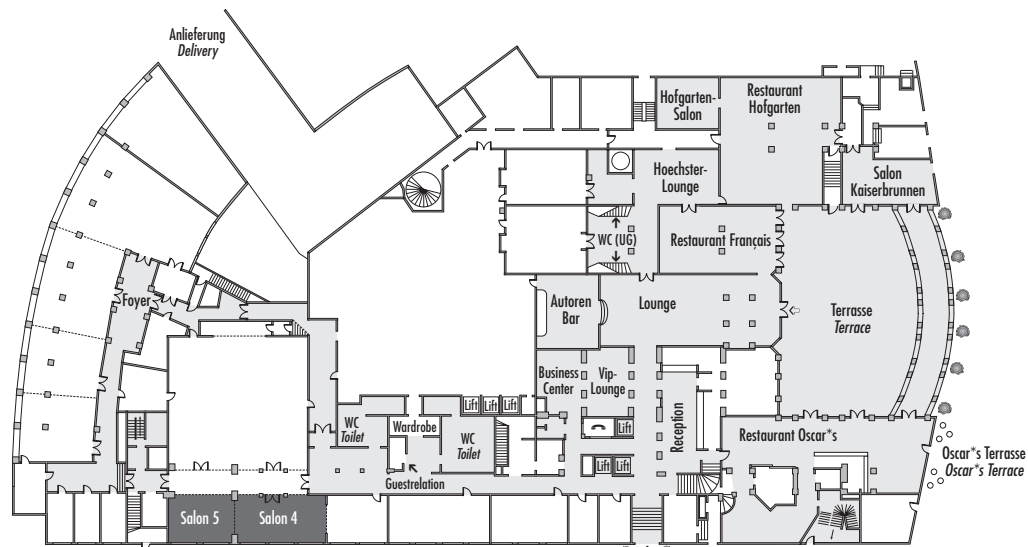
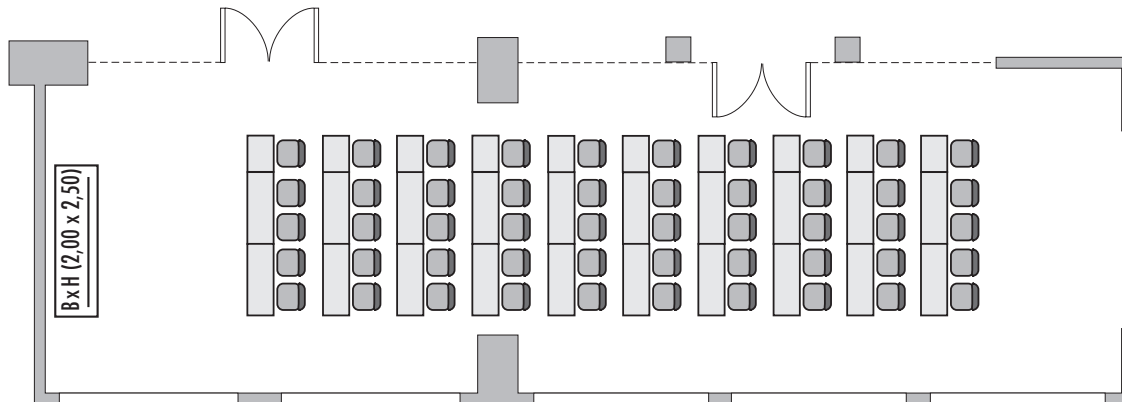

Erdgeschoss - Ground Floor

*Änderungen und Irrtum vorbehalten - Changes and errors expected