

Steigenberger Hotel Remarque

Gmünd

| Fläche (m ²) Size (sqm) | Höhe Height (m) | Länge Length (m) | Breite Width (m) | Türgröße Door Dimensions (m) | Flächenlast (kg/m ²) Max. Weight (kg/sqm) |
|--|--------------------|---------------------|---------------------|---------------------------------|--|
| 21,90 | 3,37 | 6,05 | 3,62 | 0,95 x 2,47 | 500 kg/m ² |



Parlamentarisch
Class room

-



Stuhlreihen
Theatre

-



U-Form
U-Shape

-



Block
Board room

-



Bankett
Round tables

10



Empfang
Reception

-

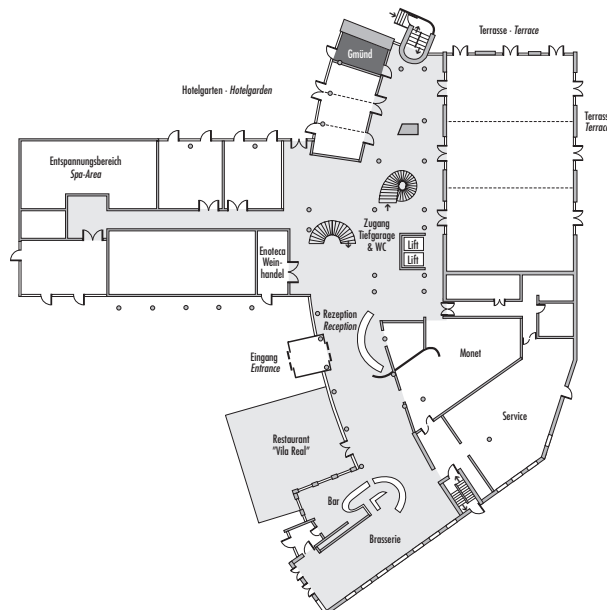
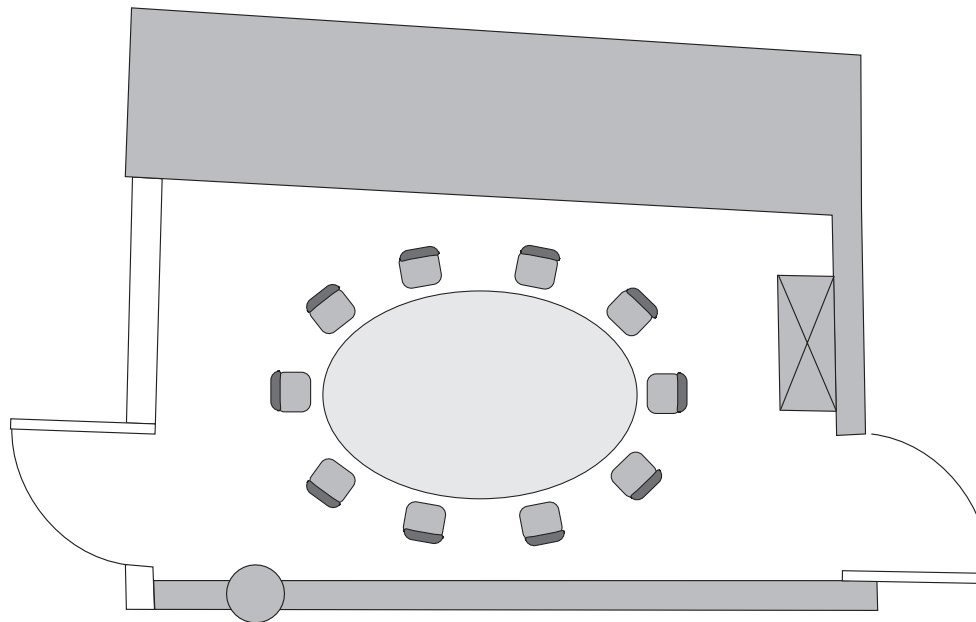

Erdgeschoss - Ground Floor

*Änderungen und Irrtum vorbehalten - Changes and errors expected



Verfügbare Stromanschlüsse - Available plug connections



Datenanschluss, Telefon / Fax- Anschluss, - Data outlet, Phone / Fax outlet



WLAN - Wireless fidelity



Feste Einbauten - Fixtures



Leinwand - Screen, 1 x 2,40m x 2,40m



Ebenerdiger Zugang - Level access

Steigenberger Hotel Remarque · Natruer-Tor-Wall 1 · 49076 Osnabrück · Germany

Telefon: +49 541 6096-0 · Telefax: +49 541 6096-600

osnabrueck@steigenberger.de · www.osnabrueck.steigenberger.de