

# Steigenberger Mannheimer Hof

## Neckartal

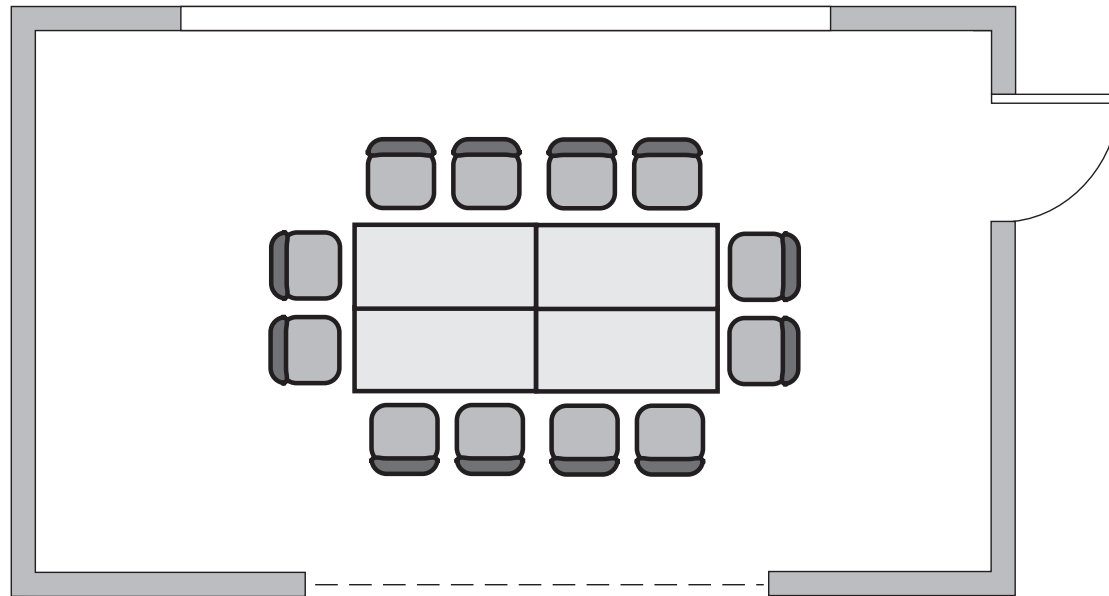

| Fläche (m <sup>2</sup> )<br>Size (sqm) | Höhe<br>Height (m) | Länge<br>Length (m) | Breite<br>Width (m) | Türgröße<br>Door Dimensions (m) | Flächenlast (kg/m <sup>2</sup> )<br>Max. Weight (kg/sqm) |
|----------------------------------------|--------------------|---------------------|---------------------|---------------------------------|----------------------------------------------------------|
| 34,00                                  | 2,70               | 4,00                | 8,50                | 0,82 x 2,04                     | 450 kg/m <sup>2</sup>                                    |



Parlamentarisch  
Class room  
-



Stuhlreihen  
Theatre  
25



U-Form  
U-Shape  
-



Block  
Board room  
12



Bankett  
Round tables  
20



Empfang  
Reception  
45

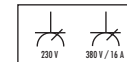

Verfügbare Stromanschlüsse · Available plug connections



Datenanschluss, Telefon / Fax Anschluss, · Data outlet, Phone / Fax outlet,



W-LAN · Wireless fidelity, 1 x ISDN Anschluss · 1 x ISDN outlet



Leinwand · Screen



Ebenerdiger Zugang · Level access

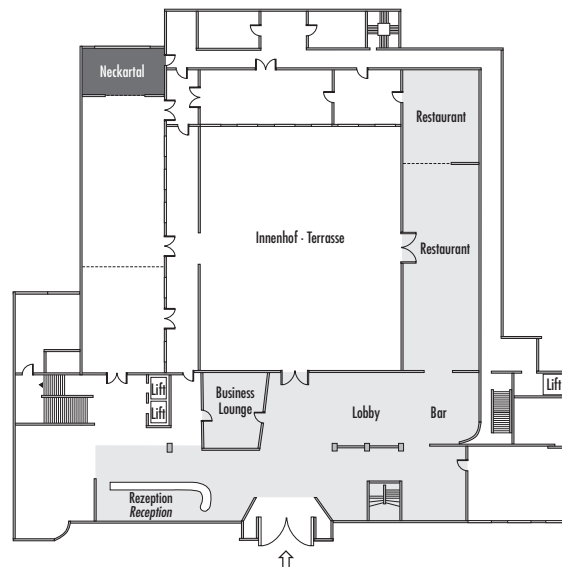

Erdgeschoss · Groundfloor

\*Änderungen und Irrtum vorbehalten · Changes and errors expected

Steigenberger Mannheimer Hof · Augustaanlage 4-8 · 68165 Mannheim · Germany  
 Telefon: +49 621 40 05-0 · Telefax: +49 621 40 05-1 90  
 mannheim@steigenberger.de · www.mannheim.steigenberger.de